

Installation Instructions for  
307020982 or 307603505 FEMCO Weather Brake  
Fits: John Deere 50, 520, 60, 620, 70, 720

Listed and shown below are the parts required to install the 982 or 3505 Weather Brake. Carefully study the photographs and identify all parts before starting assembly. Verify that all parts are in the box. Follow the installation steps numerically.

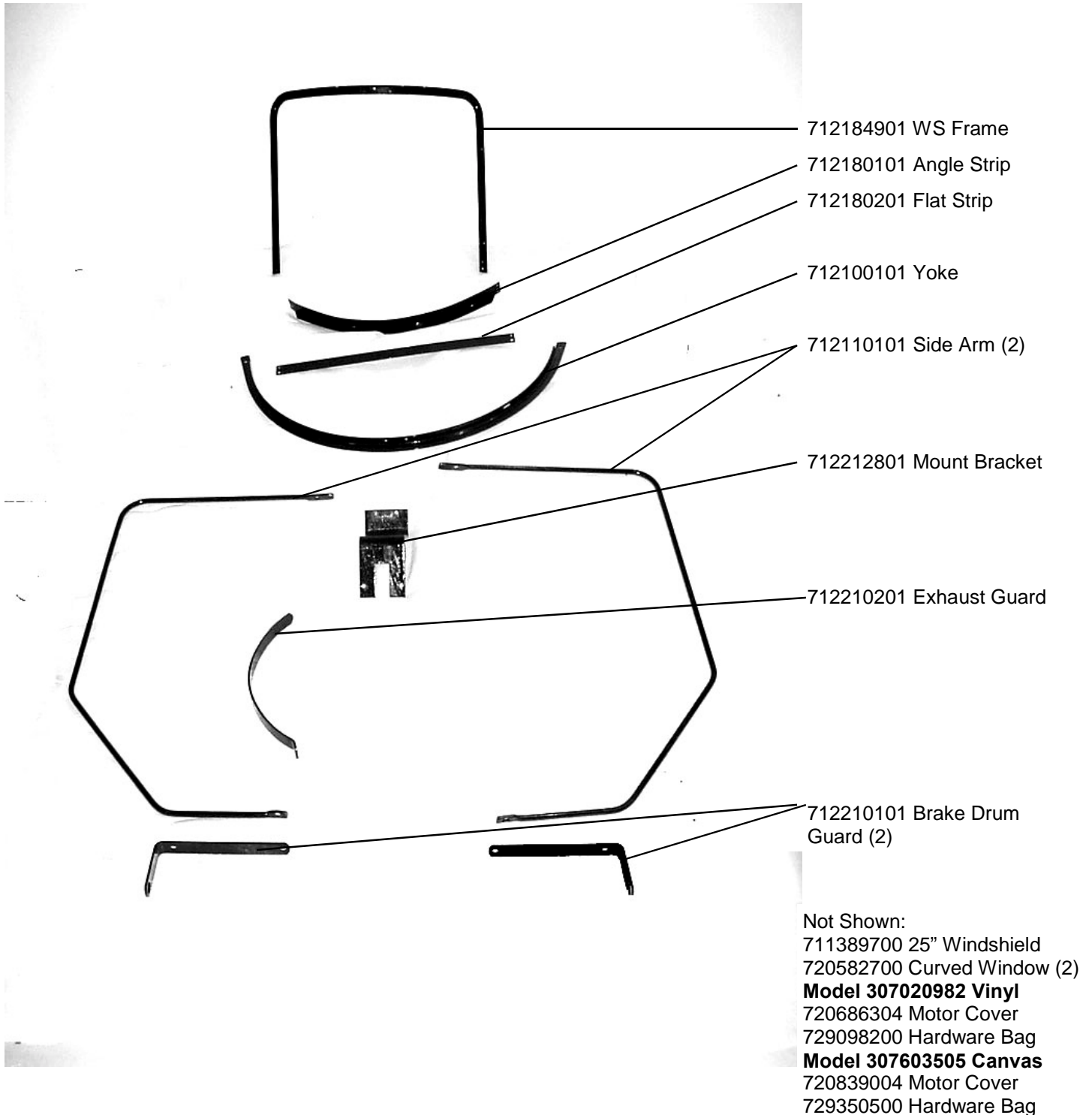

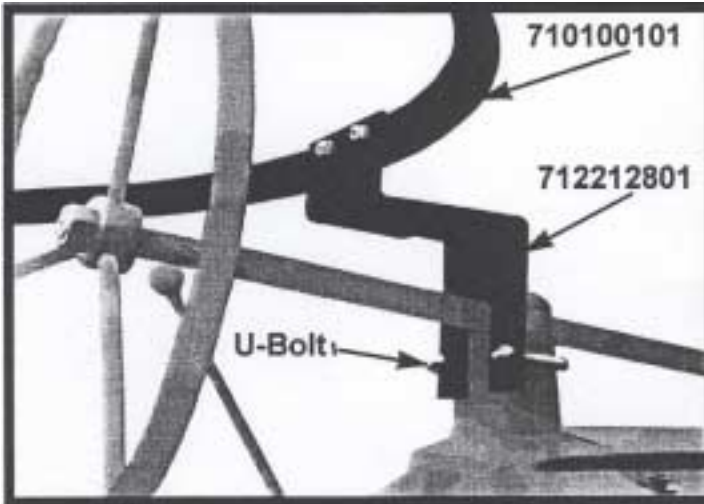

Figure 1

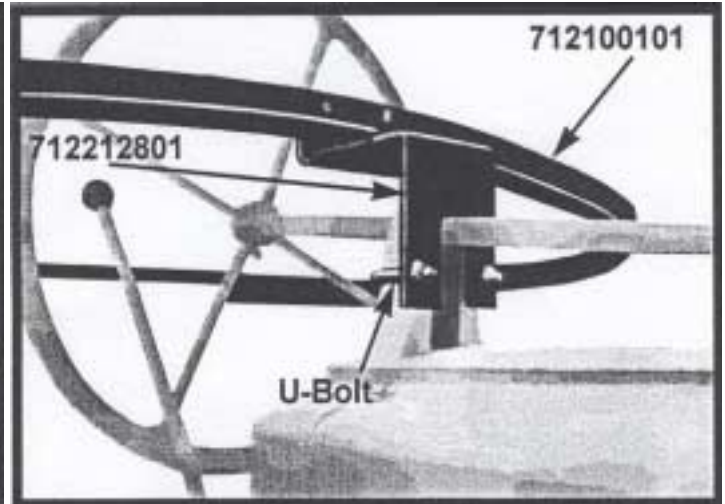

Figure 2

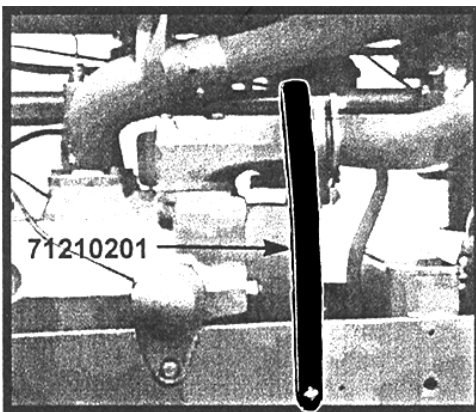

Figure 3

1. Attach # 712212801 Mount Bracket to steering column using U-Bolt.

**Model 50, 520, 60, 620 place Mount Bracket on back side of steering column support. See Figure 1**

**Model 70, 720 place Mount Bracket on front side of steering column support. See Figure 2**

2. Attach # 712210201 Exhaust Guard to right side of tractor over exhaust system so Motor Cover does not contact exhaust. See Figure 3

3. Attach # 712210101 Brake Drum Guard to the front side of the rear axle housing. Install one guard on each side of the tractor. See Figure 4

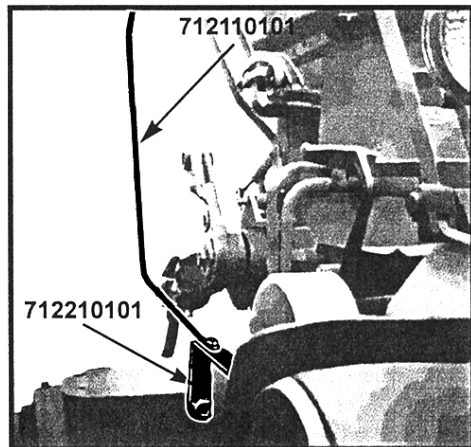

Figure 4

4. Insert # 712100101 Yoke into wide hem at the top center of the Motor Cover. Insert # 712110101 Side Arm into the wide hem on each side of the Motor Cover. Place the cover over the tractor and attach the Yoke to the Mount Bracket using two 1/4x3/4" hex bolts and nuts. Place the bolt heads to the front and the nuts to the rear of the assembly.

5. Attach the top of the Side Arms to each end of the Yoke using 3/8x1 1/2" hex bolt and wing nut. Place the bolt head under the assembly and the nut on top. Attach the lower end of the Side Arm to the Brake Drum Guard using a 3/8x1 1/2" hex bolt and nut.

6. Straighten the Motor Cover on the tractor. Tie straps to grommets on side of the Motor cover. Attach springs to grommets on the other side of the Motor Cover. Attach straps to springs using buckles. Adjust straps so tension is maintained on springs.

## WINDSHIELD/SIDE WINDOW ASSEMBLY INSTRUCTIONS

The pictures shown are generic drawings. The part shapes shown may vary from the parts supplied with this WB. The descriptions should be correct. Follow the instructions by step.

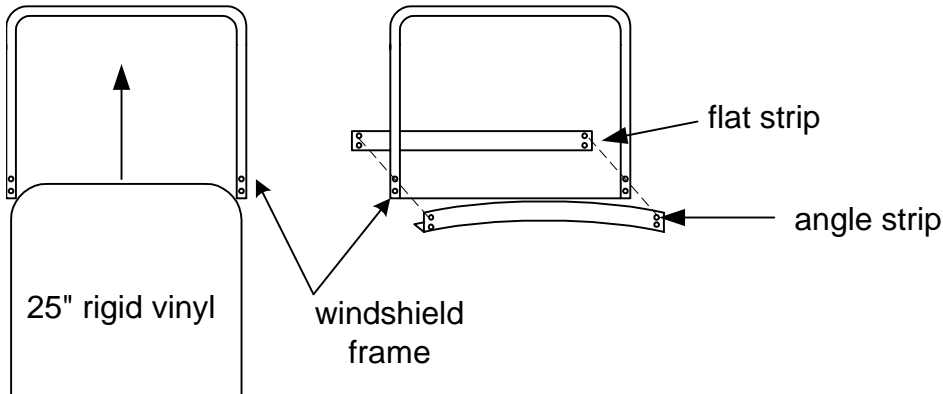

1. Slide the rigid vinyl into the windshield frame

2. Fasten the flat strip and angle strip to the windshield frame using 2 - 3/16 x 3/4 bolts in the top holes. Tighten nuts.

3. Cut slots in RH curved window to match holes in frame. Insert F1 clips in slots, around wire, and bolt to frame using 2- 3/16 x 3/4" bolts and nuts

4. Repeat step 3 for LH side window.

5. Place windshield assembly on yoke so lower RH hole aligns with slot in yoke. Bolt to yoke using 1/4 x 1 bolt and nut.

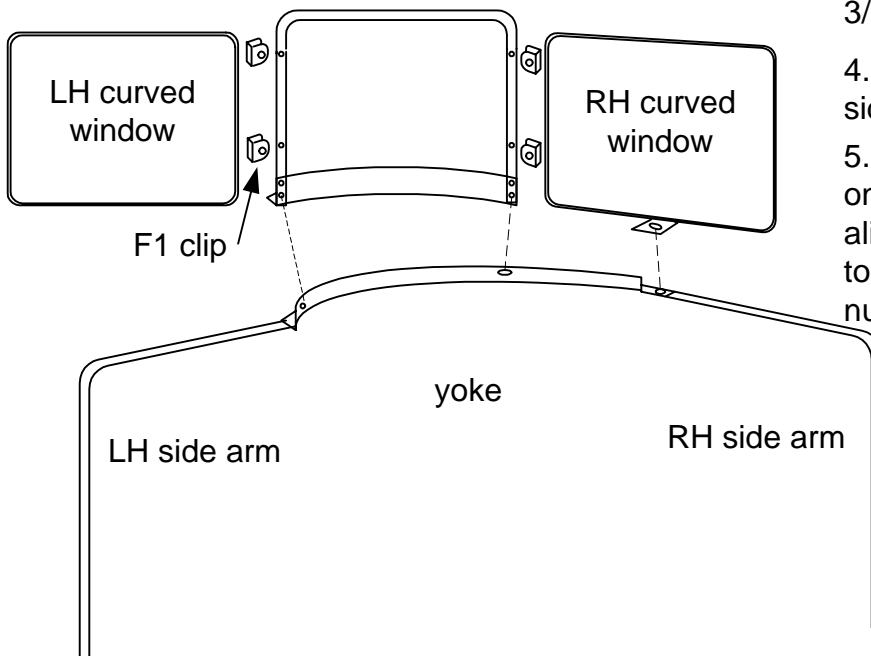

6. Align lower LH hole to hole in yoke. Bolt to yoke using 1/4x1 bolt and nut.

7. Remove the nut and place the bottom of the RH side window over the existing bolt at the yoke/ side arm. Replace the nut. Repeat procedure for LH side window.



General Offices  
1132 W. 1ST STREET  
Mcpherson, KS 67460  
Phone: 620-241-3513  
Toll Free 1-800-677-0898  
Fax: 620-241-3532  
[www.femcomfg.com](http://www.femcomfg.com)

