

Installation Instructions for 307021477 or 307603587 FEMCO Weather Brake

Fits: John Deere 850 & 950 Up or Down Exhaust, with or w/o power steering

Listed and shown below are the parts required to install the 1477 or 3587 Weather Brake. Carefully study the photographs and identify all parts before starting assembly. Verify that all parts are in the box. Follow the installation steps numerically.

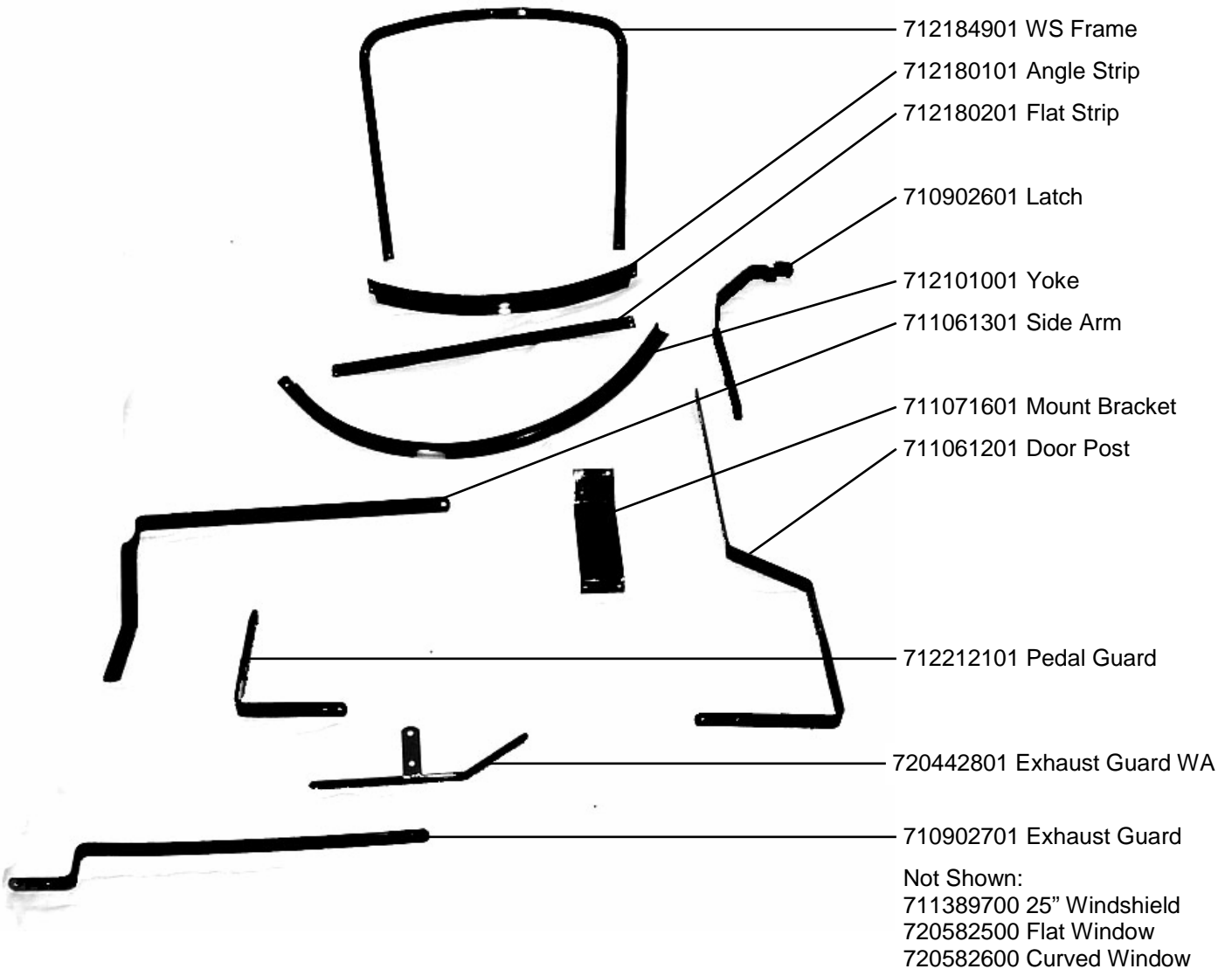

Model 307021477 Vinyl
720719904 Motor Cover
720720004 Door Assembly
729147700 Hardware Bag

Model 307603587 Canvas
720862704 Motor Cover
720862804 Door Assembly
729358700 Hardware Bag

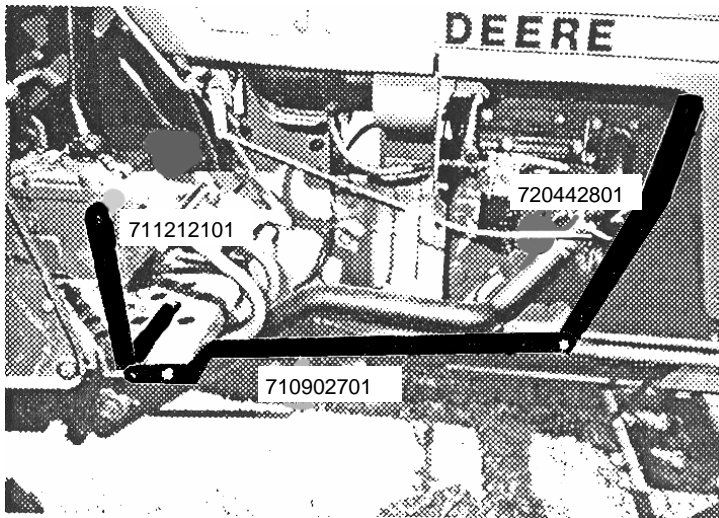

Figure 1

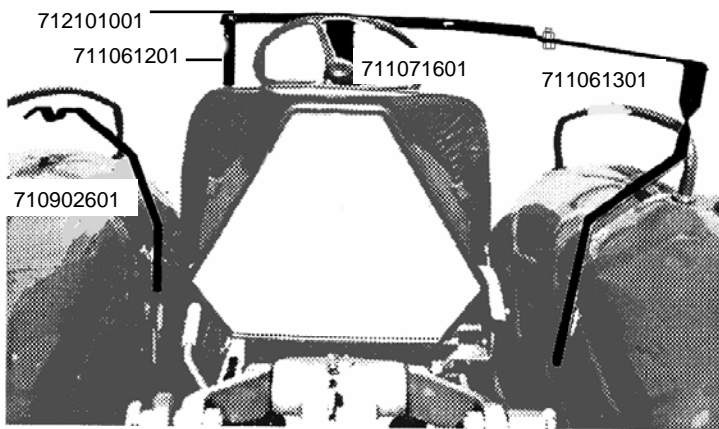

Figure 3

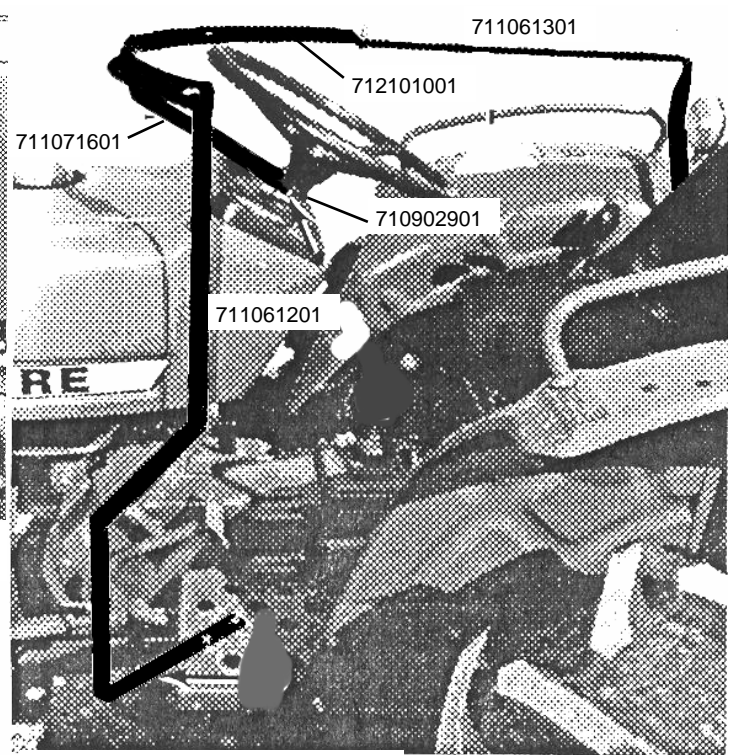
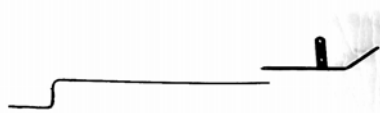

Figure 2

1. Attach # 711071601 Mount Bracket and # 710902901 Collar to steering column using 5/16x2" U-bolt
See Figure 2 & 3

2. Place Pedal Guard on right side of platform so Motor Cover is held away from brake pedal. Attach to platform using 3/8x1 1/2" hex bolt, cupped washer and nut.
See Figure 1



3. **DOWN EXHAUST ONLY:** Attach # 710902701 Exhaust Guard to front outside hole in platform using 3/8x1 1/2" hex bolt and nut. Attach # 720442801 Exhaust Guard WA to # 710902701 Exhaust Guard using 3/8x1 1/2" hex bolt and nut. Clamp Exhaust Guard WA to exhaust pipe 5/16x1 3/4" U-bolt. See Figure 1

Step 3

4. **UP EXHAUST ONLY:** Remove patch from cut out on right side of Motor Cover, button strap behind exhaust after Motor Cover is installed



5. Place Motor Cover over tractor. Insert # 712101001 Yoke into wide hem at the top of the cover. Attach the Yoke to the Mount Bracket using two (2) 1/4x3/4" hex bolts and nuts. Place the bolt heads to the front and the nuts to the rear of the assembly.
See Figure 2

Step 5

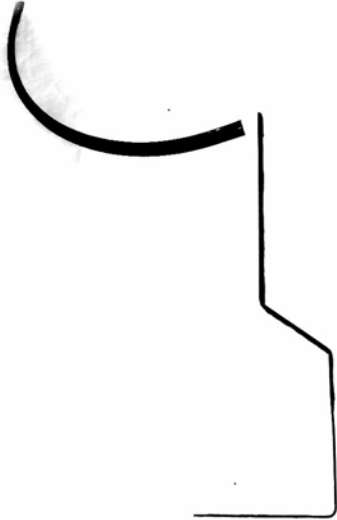

6. Insert # 711061201 Door Post into wide hem on the left side of the Motor Cover. Attach the top of the Door Post to the Yoke using a 1/4x1" hex bolt and nut. Place the bolt head to the rear and the nut to the front of the assembly. Attach the bottom of the Door Post to the platform using two (2) 3/8x1 1/2" hex bolt, cupped washer and nut.

Step 6

7. Insert # 711061301 Side Arm into the wide hem on the right side of the Motor Cover. Attach the Side Arm to the end of the Yoke using a 3/8x1 1/2" hex bolt and wing nut. Place the bolt head below and the nut on top of the assembly.

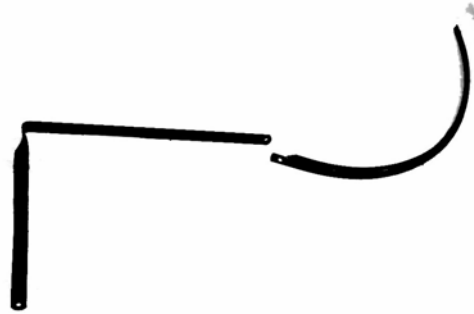

8. Straighten the Motor Cover on the tractor. Tie straps to grommets on side of the Motor cover. Attach springs to grommets on the other side of the Motor Cover. Attach straps to springs using buckles. Adjust straps so tension is maintained on springs.

Step 7

9. Find hinge holes in Door Post and punch holes through Motor Cover at hole locations. Place Door Assembly level with the bottom of the Yoke and mark Door post hole locations. Cut slits in Door Assembly around wire frame and insert F1 clips. Attach F1 clips to Door Post using 3/16x3/4" hex bolts and nuts. Tie straps sewn on Motor cover to Door Assembly grommets. See Window Assembly Instructions

10. Place # 710902601 Latch up under the bottom of the door frame. Using the Latch as a template mark and drill 13/32" diameter holes in the fender. Attach the Latch to the fender using two (2) 3/8x1 1/2" hex bolts and nuts.

WINDSHIELD/SIDE WINDOW ASSEMBLY INSTRUCTIONS

The pictures shown are generic drawings. The part shapes shown may vary from the parts supplied with this WB. The descriptions should be correct. Follow the instructions by step.

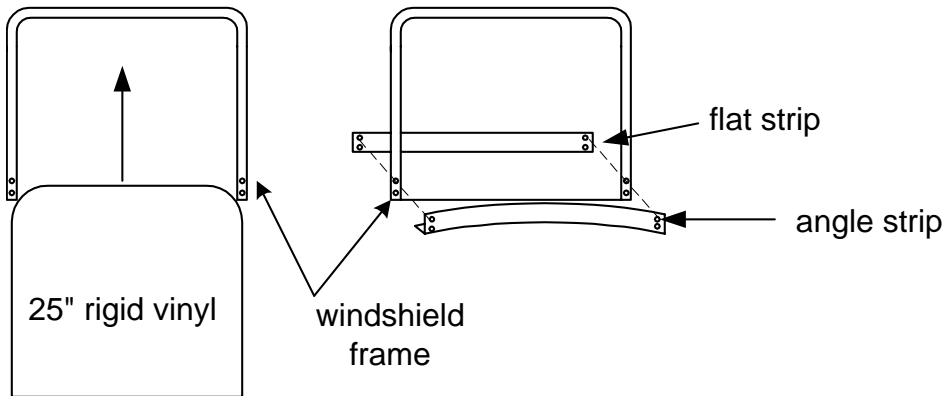

1. Slide the rigid vinyl into the windshield frame
2. Fasten the flat strip and angle strip to the windshield frame using 2 - 3/16 x 3/4 bolts in the top holes. Tighten nuts.

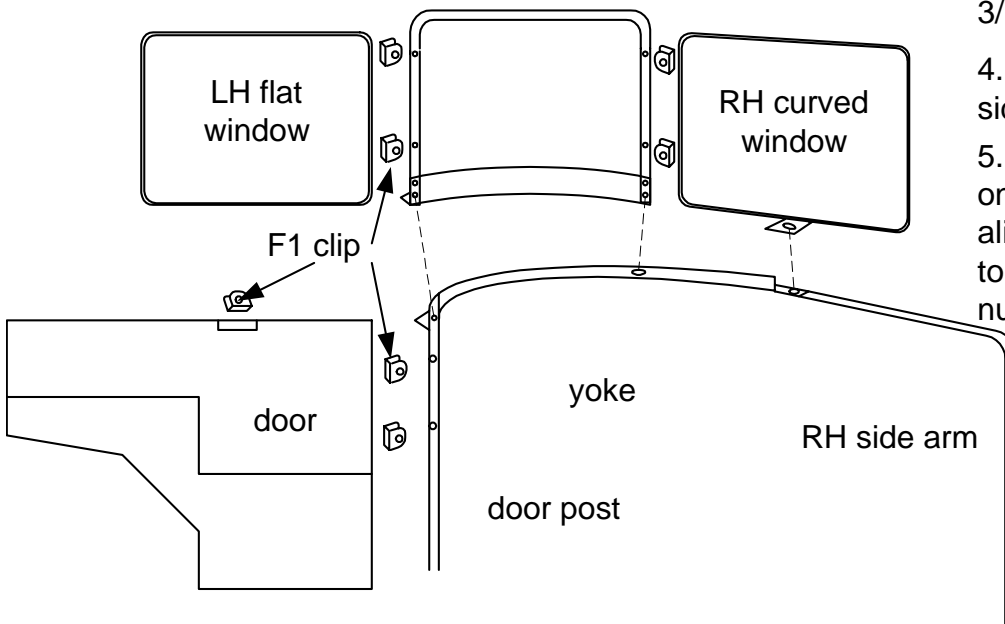

3. Cut slots in RH curved window to match holes in frame. Insert F1 clips in slots, around wire, and bolt to frame using 2- 3/16 x 3/4" bolts and nuts
4. Repeat step 3 for LH side window.
5. Place windshield assembly on yoke so lower RH hole aligns with slot in yoke. Bolt to yoke using 1/4 x 1 bolt and nut.

6. Remove nut, place lower LH hole over existing bolt at door post/yoke and replace nut.

7. Remove the nut and place the bottom of the RH side window over the existing bolt at the yoke/ side arm. Replace the nut.

8. Place an F1 clip through the cut out in the top of the door. Punch a small hole through the vinyl in the LH side window and bolt using a 3/16 x 3/4 bolt and nut



General Offices
1132 W. 1ST STREET
Mcpherson, KS 67460
Phone: 620-241-3513
Toll Free 1-800-677-0898
Fax: 620-241-3532
www.femcomfg.com